



For use with :

DOSATRON®

■ ■ ■ ■ ■ *Because life is powered by water®*

DOUBLE CHECK VALVE

- Helps protect against the risk of backflow.
- Compact lightweight construction for easy installation.
- Suitable for use with Dosatron D07, D25 and D3 ranges.
- Suitable for all Class 3 contamination risks as per Water Supply (water fittings) Regulations 1999.

Materials

| | | |
|------------------|---|------------------|
| Body | - | DZR Brass |
| Seals | - | EPDM |
| Check Cartridges | - | Acetyl Copolymer |
| Spring | - | Stainless Steel |

Specification

| | | |
|---------------------|---|---------------------------|
| Working pressure | - | 0.1 bar min./ 16 bar max. |
| Maximum temperature | - | 85°C |

Standards and Approvals

BSEN 13959
WRAS Approved

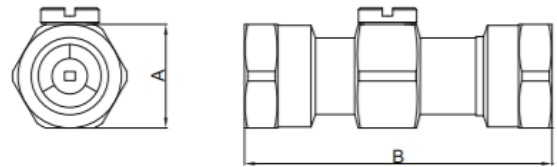

| Connection | A | B |
|------------|-------|-------|
| 3/4" FBSP | 31 mm | 87 mm |



HingeroseLTD

SALES | SERVICING | SUPPORT

Unit 4 Henson Park, Henson Way, Kettering, Northamptonshire, NN16 8PX
tel. +44 (0)1536 461441 / e-mail: info@hingerose.co.uk